

Dimensions

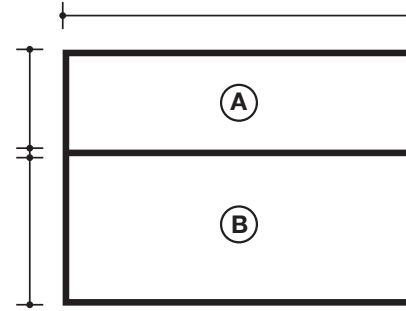

Ⓐ Height : _____ Total height : _____

Ⓑ Height : _____ Width : _____

Standard dimensions

- 60 po. (H) X 48 po. (W)
- 60 po. (H) X 72 po. (W)
- 60 po. (H) X 96 po. (W)
- Others _____

Moulding # 959

- Natural anodised
- Black anodised
- Others : _____

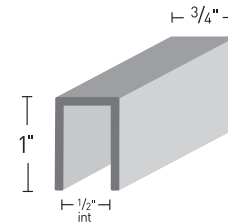

Feet

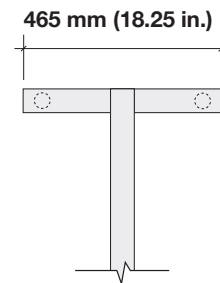

Steel tubular

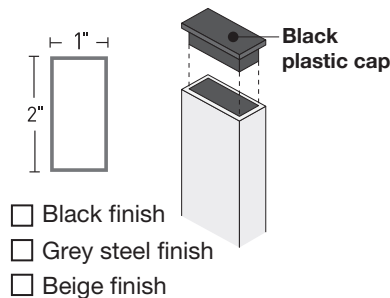

- Black finish
- Grey steel finish
- Beige finish

755F

QUANTITY :

DATE :

Surfaces and colors

(W) : writing surface
(D) : display surface

- Ⓐ Ⓑ Ⓒ Ⓓ White laminite (W)
- Ⓐ Ⓑ Ⓒ Ⓓ Lauzonite (W) grey green black
- Ⓐ Ⓑ Ⓒ Ⓓ Porcelain (W) white green black
- Ⓐ Ⓑ Ⓒ Ⓓ Decorative finish (D) _____
- Ⓐ Ⓑ Ⓒ Ⓓ Natural cork (D) _____
- Ⓐ Ⓑ Ⓒ Ⓓ Colored cork (D) _____
- Ⓐ Ⓑ Ⓒ Ⓓ Fabric (D) _____
- Ⓐ Ⓑ Ⓒ Ⓓ Others _____

To visualize the colors please consult
or website at www.cctn.com

Notes :

Contractor:

Architect:

Project:

Address: