

Dimensions

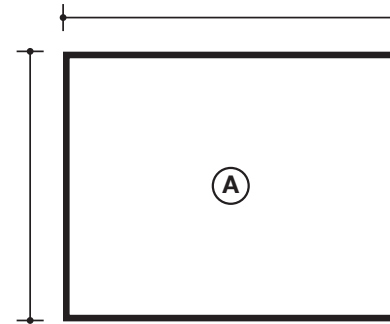

Height : _____ Width : _____

Standard dimensions

- 60 po. (H) X 48 po. (W) Others _____
- 60 po. (H) X 72 po. (W) _____
- 60 po. (H) X 96 po. (W) _____

Moulding # 959

- Natural anodised
- Black anodised
- Others : _____

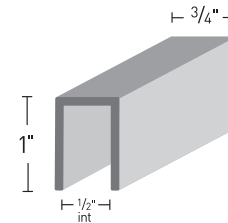

Feet

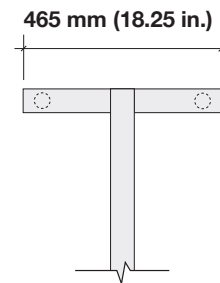

Steel tubular

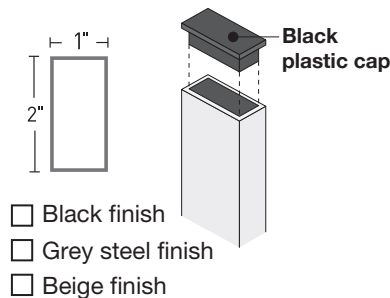

755

QUANTITY :

DATE :

Surfaces and colors

(W) : writing surface
(D) : display surface

- (A) (B) White laminite (W)
- Lauzonite (W) grey green black
- Porcelain (W) white green black
- Decorative finish (D) _____
- Natural cork (D) _____
- Colored cork (D) _____
- Fabric (D) _____
- Others _____

To visualize the colors please consult
or website at www.cctn.com

Notes :

Contractor:

Architect:

Project:

Address: